



UNLEASH YOUR CREATIVITY!



Model SC-EGGLIGHT

### PARTS LIST

QTY.	ID	NAME	Part #
□ 2	1	Single Snap	6SC01
□ 1	B3B	Battery Holder	6SCB3B
□ 1	D12	Color2 LED	6SCD12
□ 3		Egg	6SCEGG
□ 4		Basket Pattern	6SCBASK

#### IMPORTANT:

If any parts are missing or damaged,  
**DO NOT RETURN TO RETAILER.**  
e-mail us at: support@elenco.com.

You may order additional / replacement parts:  
elenco.com/replacement-parts

#### Installing batteries:

- Remove the safety cover from the battery holder (if your holder has one) with a Phillips head screwdriver.
- Insert three (3) 1.5V AA batteries (not included) in the holder. Be sure to orient the battery "+" as marked in the holder.
- Replace the cover (if your holder has one). When installing a battery, be sure the spring is compressed straight back, and not bent up, down, or to one side.
- Battery installation should be supervised by an adult.



STEAM

SC-EGGLIGHT\_V1

## Assembly: Build your Egg Light

### Light it up

- Snap both single snaps on the battery holder.
- Snap the COLOR2 LED on the single snaps. Place the LED '+' facing the same direction as the battery holder '+'.  
• Place one of the eggs on top of the LED and watch it slowly change colors. For best effects, place the parts in a dimly lit room.
- Unsnap one side of the COLOR2 LED to turn off.

### STEP 1

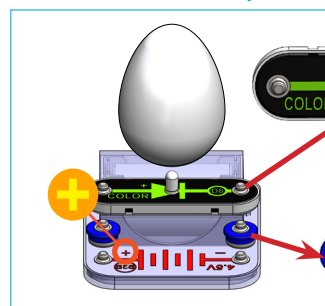

### STEP 2

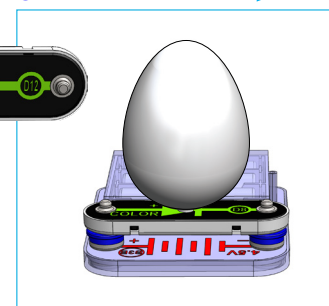

#### What is an LED? How does it work?

An LED (Light Emitting Diode) is a semiconductor device that emits light when activated. They act as a one-way valve that allows electricity to flow in only ONE direction. When positioned in the circuit, if the + side is facing the + terminal of the source, then electricity will flow through it. If they face opposite sides, the LED stops all flow of electricity. LEDs are commonly used as indicator lights and often for home lighting because they are more energy efficient than incandescent light bulbs.



**CREATIVITY REQUIRED**  
Use markers, stickers, paint, etc. to decorate your eggs with any design you want!



#### Batteries: X3

Install three (3) "AA" batteries  
(Full battery installation and warnings located within this manual)

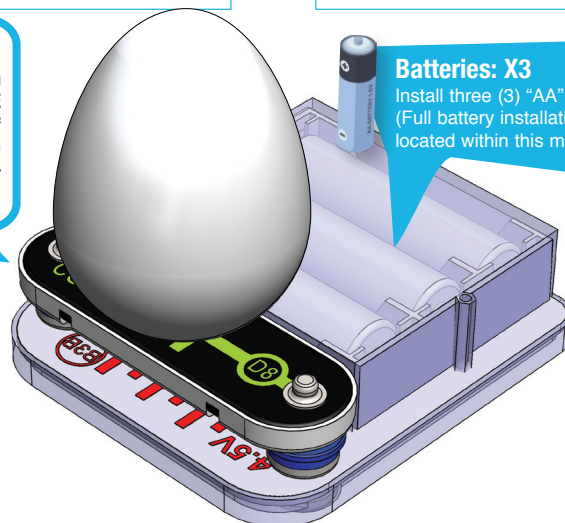

# Assembly: Put together your Basket

## Show it off!

- Take one of the pre-cut baskets and one of the handles provided.
- Insert the tab into the large side opening.
- Take the handle and insert each tab into the smaller side openings.
- Insert your decorated egg and place on top of the LED for a fun display.

## STEP 1

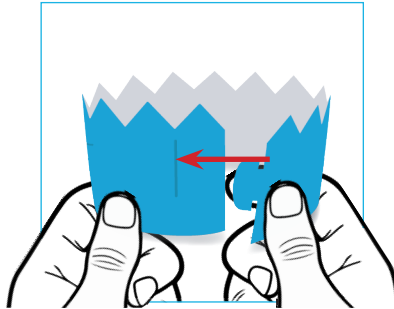

## STEP 2

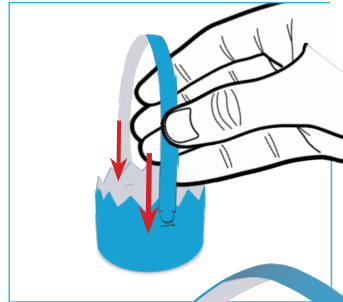

## STEP 2

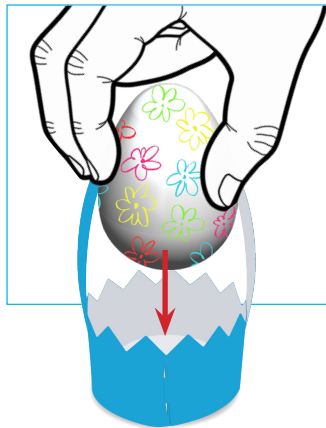

Includes 4 pre-cut baskets to try different styles!



**CREATIVITY REQUIRED**  
Use the back side of your basket to get creative and design whatever patterns you want! Use your art supplies to match your egg!



**Adult Supervision:** Because children's abilities vary so much, even with age groups, adults should exercise discretion as to which experiments are suitable and safe (the instructions should enable supervising adults to establish the experiment's suitability for the child). Make sure your child reads and follows all of the relevant instructions and safety procedures, and keeps them at hand for reference. This product is intended for use by adults and children who have attained sufficient maturity to read and follow directions and warnings.



**WARNING: SHOCK HAZARD** - Never connect Snap Circuits® to the electrical outlets in your home in any way!



**WARNING:** Moving parts. Do not touch the motor or fan during operation. Do not lean over the motor. Fan may not rise until switch is released. Do not launch fan at people, animals, or objects. Eye protection is recommended.

**WARNING:** Always check your wiring before turning on a circuit. Never leave a circuit unattended while the batteries are installed. Never connect additional batteries or any other power sources to your circuits.



**WARNING: CHOKING HAZARD**- Small parts. Not for children under 3 years.

This instruction manual must be retained since it contains important information.

## Batteries: X3



- Use only 1.5V AA type, alkaline batteries (not included).
- Insert batteries with correct polarity.
- Do not mix old and new batteries.
- Remove batteries when they are used up.
- Do not mix alkaline, standard (carbon-zinc), or rechargeable (nickel-cadmium batteries).
- Do not connect batteries or battery holders in parallel.
- Do not short circuit the battery terminals.
- Never throw batteries in a fire or attempt to open its outer casing.
- Batteries are harmful if swallowed, so keep away from small children.
- Non-rechargeable batteries should not be recharged.
- Rechargeable batteries should only be charged under adult supervision, and should not be recharged while in the product.

**If you have any problems, contact: ELENCO® ELECTRONICS, LLC**

150 Carpenter Ave. Wheeling, IL 60090 | (800) 533-2441 | support@elenco.com | elenco.com

753343

Copyright © 2023 ELENCO® Electronics, LLC. All Rights Reserved.